

Super easy cedar bird feeder build with template, and part details



This bird feeder is designed to be as easy as possible while building a great bird feeder.

The necessary skills for completing this project are cutting simple parts out of wood and assembling parts using a brad nailer.

Tools and materials needed for this project are:

- Means to cut parts out of wood
- Drill
- Glue
- Sanding block
- 1/16" drill bit
- 5/8" dowel (Optional)
- Standard office printer to print off templates
- Flexible steel ruler
- Carpentry pencil
- Utility knife
- Sacrificial cutting surface
- Painters tape
- Awl or some pointed object
- Brad nailer (1"Brad nails)
- 2X Cedar fence picket 5/8"X5-1/2"X6'
- Two small hinges
- Screw Eye 3/32 in. x 1 in.
- 1/4" Natural fiber Rope



Read through all the instructions here and on the templates before starting work.

Making your templates

Templates for all parts of this birdhouse are included and should be printed off at 100% with no added margins or headers. Template is on page 11. Next, using your ruler and utility knife, cut out the outline of the templates on your sacrificial cutting surface. Reusable templates can be made by printing on a more durable material or tracing and transferring all the information onto a more durable material. (Image dose not match template on these plans)

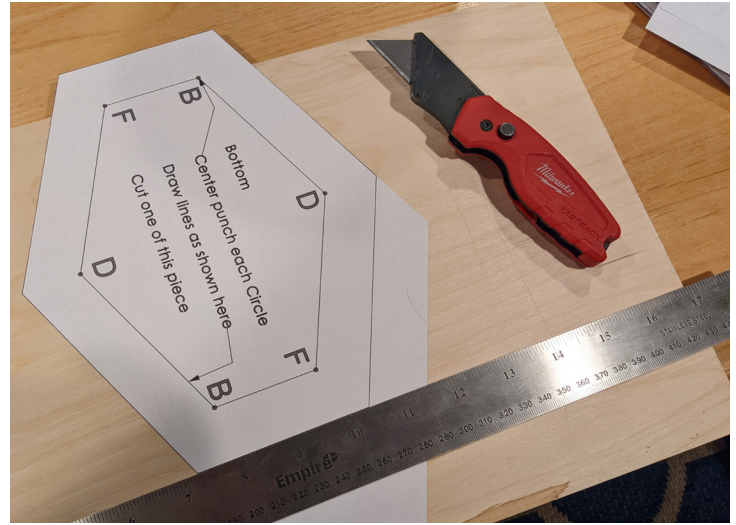

Choosing a workpiece

- This bird feeder was designed to be built out of cedar fence pickets 5/8"X5-1/2"X6'. but any material close to 5/8" in thickness can be used

- Draw parts onto your workpiece
(Image dose not match template on these plans)

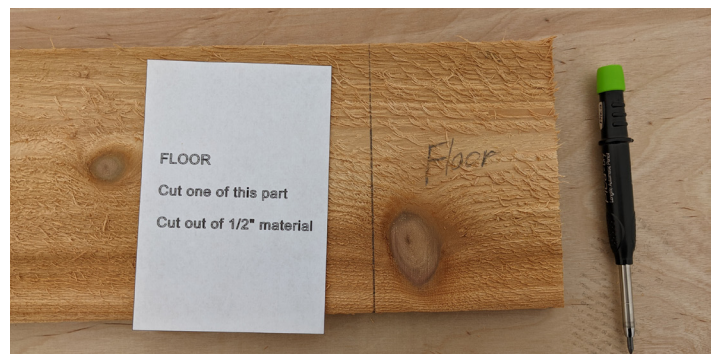
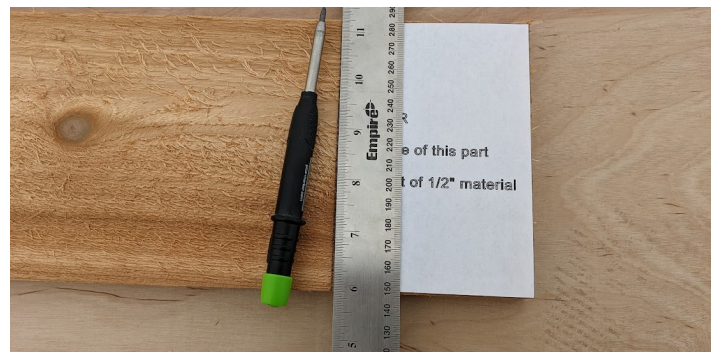

- Refer to the diagrams on the following three pages. Using the dimensions specified in these diagrams, carefully cut out all the required parts. Note: diagrams are in inches, not to scale and the grain direction may not match images.
- The perch can be constructed using a dowel of a similar size.

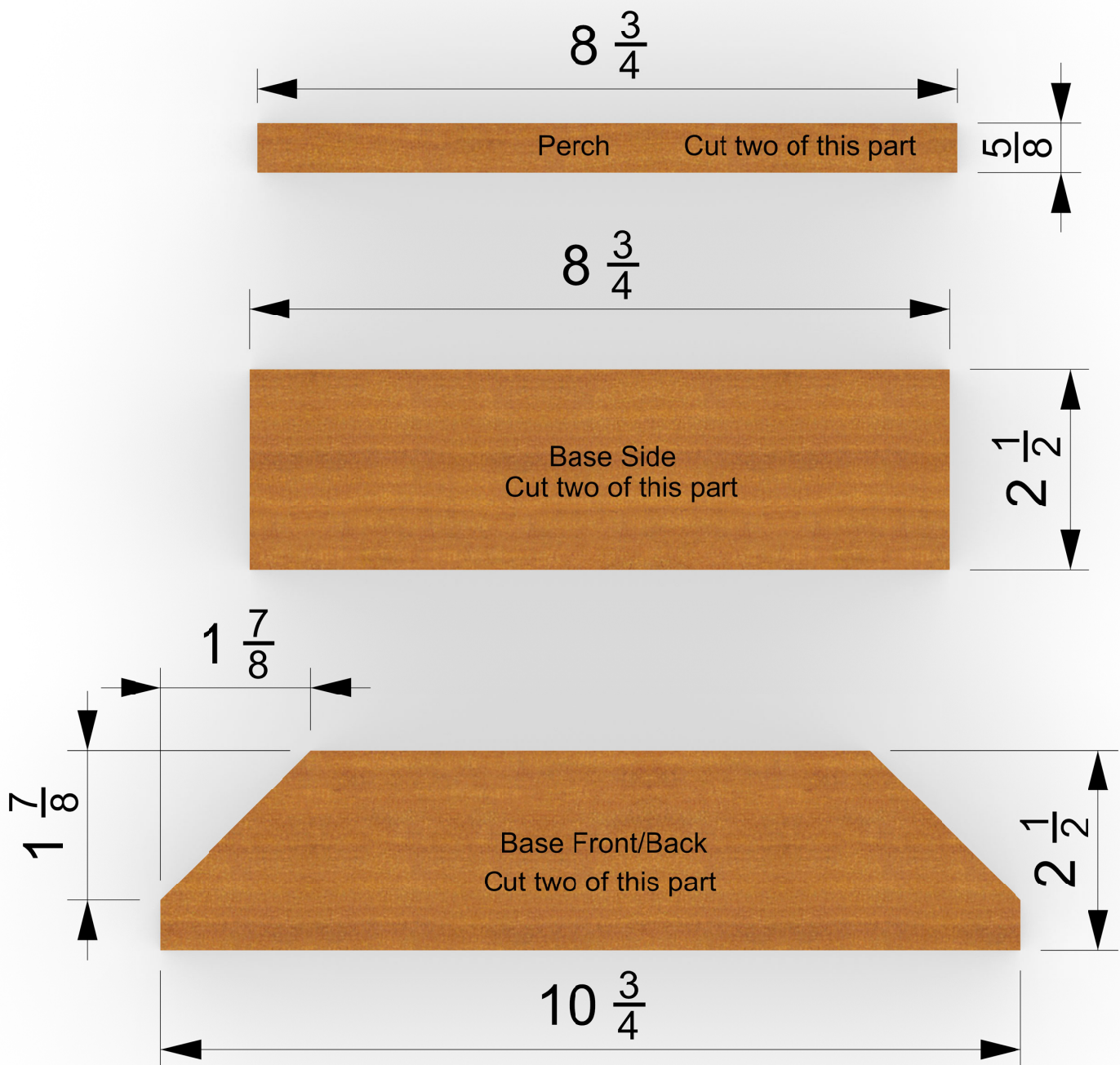

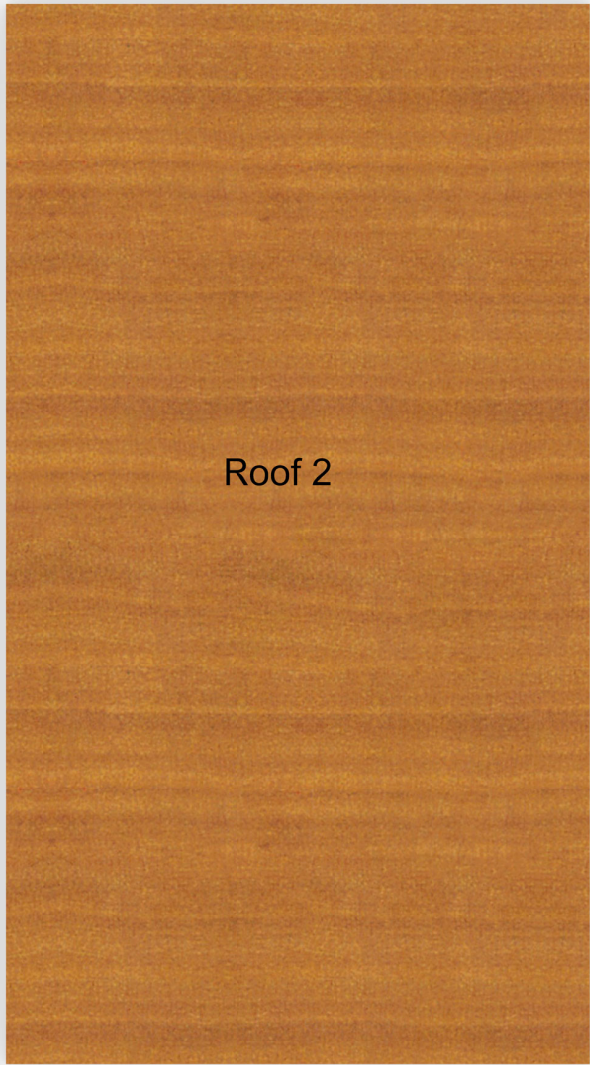

Roof 2



10

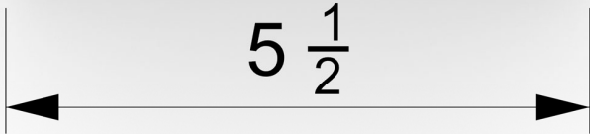

5 $\frac{1}{2}$

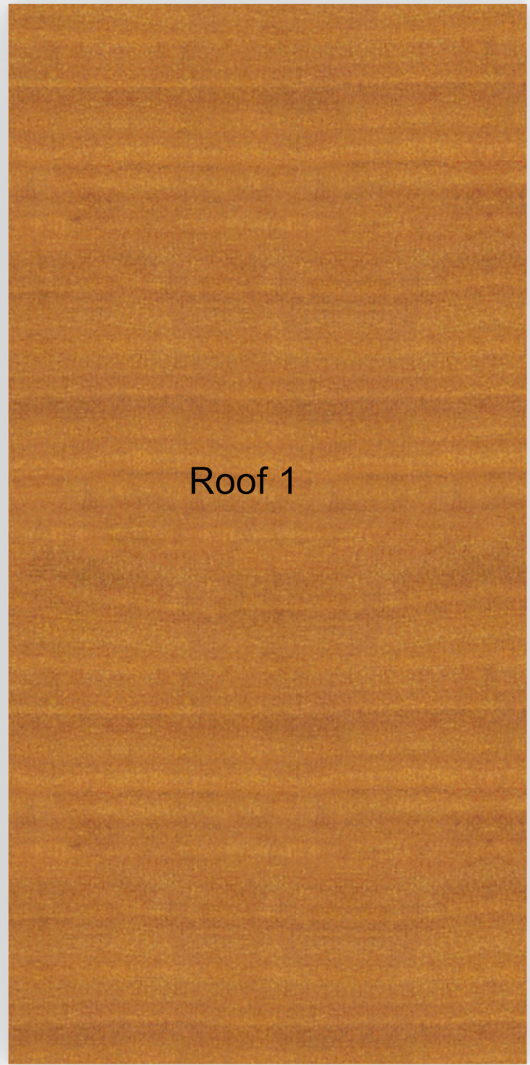

Roof 1



10

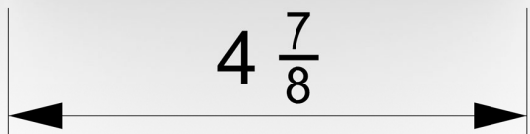

4 $\frac{7}{8}$

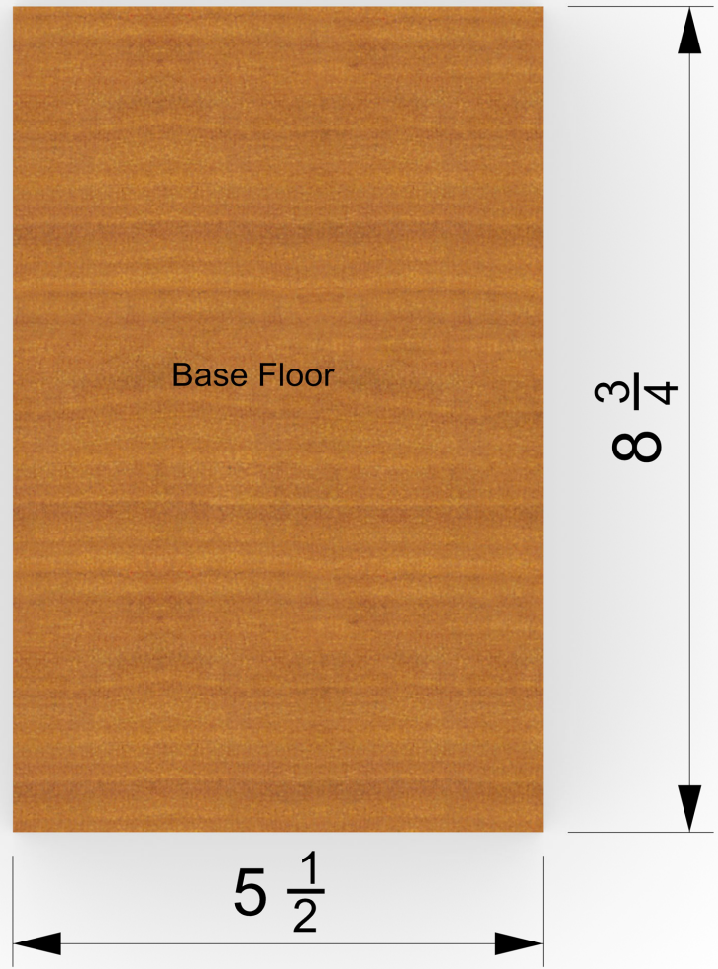
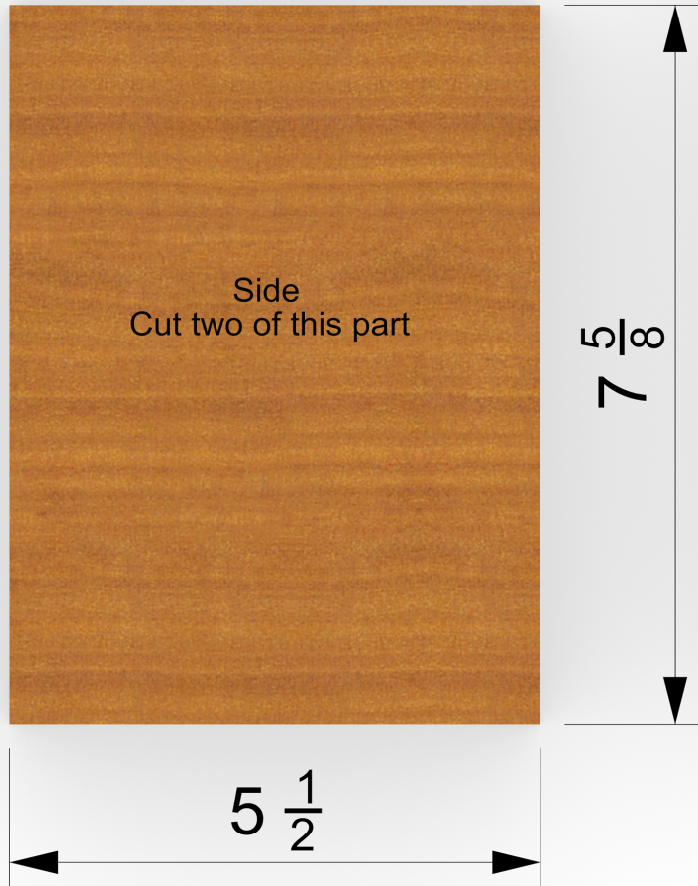

Sand all the parts

- Give all the parts a light sanding with 120 grit to get rid of any splintery or stringy bits. (Don't over sand)



- Follow the assembly diagrams
- Glue and Bradnail parts together.
- Use a damp washcloth to remove any excess glue.



- Draw a Center line on the top of the existing assembly and line it up with the center punch on the front and back Parts







- Connect Roof 2 with Hinges only. (Pilot holes are recommended)
- Drill Pilot holes for the screw eyes near the top of Roof 1 and screw them in.
- Cut a length of the natural fiber Rope, thread an end through one of the screw eyes, and knot the end of the rope.
- Do the same to the other side once you locate the feeder.



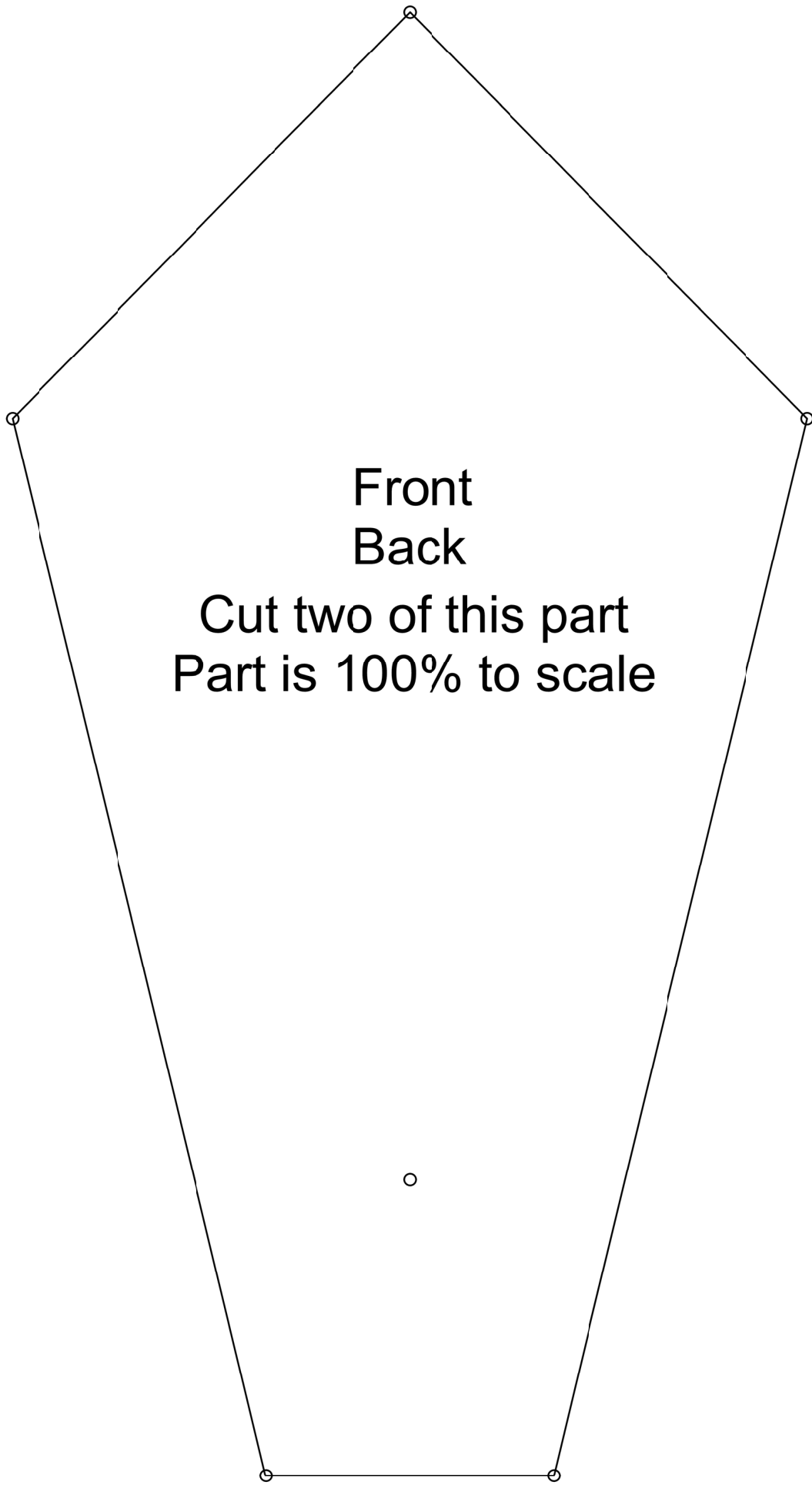

Your bird feeder build is complete!

Now you can personalize it just the way you want.

A homemade gift is always more thoughtful than a store-bought gift.

I hope you found this build fun, and that you learned something along the way.

Thank you for your support!