

UNLESS OTHERWISE SPECIFIED:  
 DIMENSIONS ARE IN INCHES  
 TOLERANCES:  $\pm 0.0625$  in

|                      | NAME | DATE |
|----------------------|------|------|
| DRAWN                |      |      |
| CHECKED              |      |      |
| COMMENTS:            |      |      |
| DO NOT SCALE DRAWING |      |      |

|  |          |              |  |
|--|----------|--------------|--|
| TITLE:<br><b>ELEVATED GARDEN PLANTER</b> |          |              |  |
| SIZE<br><b>A</b>                         | DWG. NO. | REV          |  |
| <b>TITLE PAGE</b>                        |          |              |  |
| SCALE: N/A                               | WEIGHT:  | SHEET 1 OF 1 |  |

5

4

3

2

1

## COPYRIGHT

This work and any wording or graphics found in these woodworking plans are for personally use only.  
This PDF document and its contents cannot be sold or used without written permission from Zing Woodwork LLC

Plans, wording and graphics Copyright owned by Zing Woodworks LLC

## SAFETY WARNING

Woodworking machinery can cause injury from improper operation or from poor maintenance.  
Individual machines must be evaluated for specific operating hazards.

Make sure you use hand, eye and hearing protection when using power equipment & always practice safety.

Zing Woodworks LLC is not responsible for an injuries or harm caused by improper power tool use  
or any injuries related to building this project.

## TOOLS NEEDED



MITER SAW



DRILL



BRAD NAILER

## MATERIALS NEEDED

- (6) 1x4 @ 8FT LONG
- (3) 1x3 @ 8FT LONG
- (1) 1x2 @ 8FT LONG
- 16 GA NAILS
- 2" LONG EXTERIOR SCREWS
- EXTERIOR WOOD GLUE



UNLESS OTHERWISE SPECIFIED:  
DIMENSIONS ARE IN INCHES  
TOLERANCES: ±0.0625 in

|                      | NAME | DATE |
|----------------------|------|------|
| DRAWN                |      |      |
| CHECKED              |      |      |
| COMMENTS:            |      |      |
| DO NOT SCALE DRAWING |      |      |

|  |                               |              |
|--|-------------------------------|--------------|
| TITLE:<br><b>ELEVATED GARDEN PLANTER</b> |                               |              |
| SIZE<br><b>A</b>                         | DWG. NO.<br><b>NOTES PAGE</b> | REV          |
| SCALE: N/A                               | WEIGHT:                       | SHEET 1 OF 1 |

| ITEM NO. | PART NUMBER                  | MATERIAL            | QTY. |
|----------|------------------------------|---------------------|------|
| 1        | 1x4x38                       | Pine                | 6    |
| 2        | 2x2x10                       | Pine                | 4    |
| 3        | 1x2x35                       | Pine                | 2    |
| 4        | 1x3 Leg                      | Pine                | 4    |
| 5        | 1x4 Leg                      | Pine                | 4    |
| 6        | 1x4x16                       | Pine                | 6    |
| 7        | 1x4x14.25                    | Pine                | 9    |
| 8        | 1x4x14.25 Corner Cut - Short | Pine                | 1    |
| 9        | 1x4x14.25 Corner Cut         | Pine                | 1    |
| 10       | 1x3 Short Moulding           | Pine                | 2    |
| 11       | 1x3 Long Moulding            | Pine                | 2    |
| 12       | 1 in Wood Screw              | Exterior Wood Screw | 8    |
| 13       | 1 5-8 in Wood Screw          | Exterior Wood Screw | 48   |
| 14       | 1.5 in - 18 GA Brad Nails    | Galvanized Steel    | 22   |

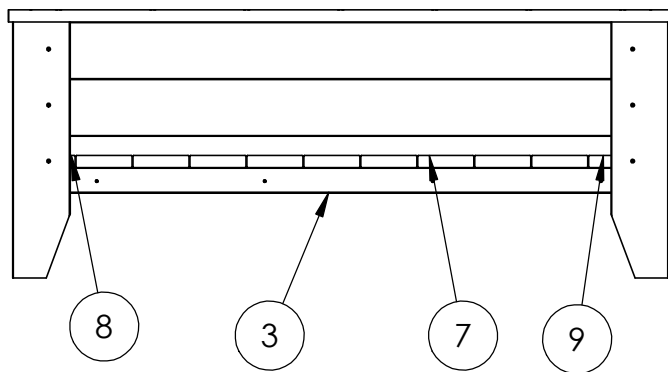
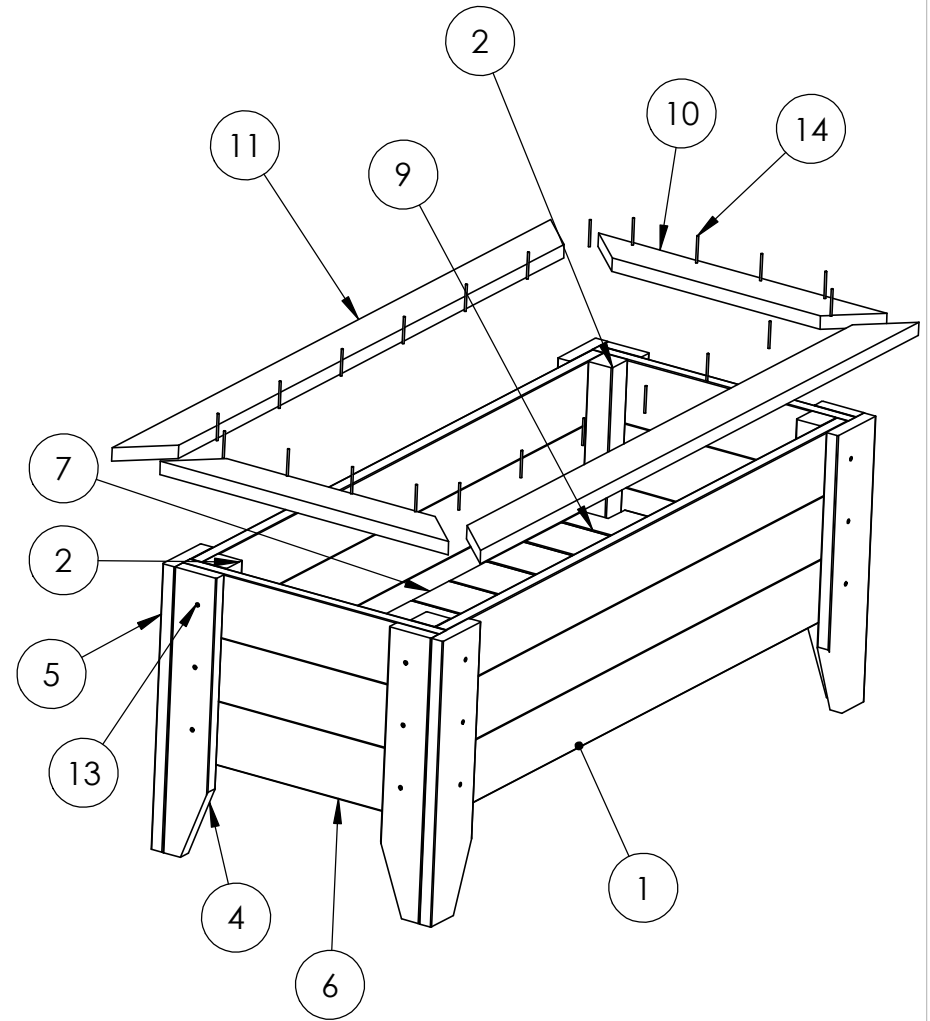

TITLE:

**ELEVATED GARDEN PLANTER**

SIZE

**A**

DWG. NO.

**TOTAL ASSEMBLY**

REV

SCALE: N/A

WEIGHT:

SHEET 1 OF 1



UNLESS OTHERWISE SPECIFIED:  
DIMENSIONS ARE IN INCHES  
TOLERANCES: ±0.0625 in

|                      | NAME | DATE |
|----------------------|------|------|
| DRAWN                |      |      |
| CHECKED              |      |      |
| COMMENTS:            |      |      |
| DO NOT SCALE DRAWING |      |      |

| ITEM NO. | PART NUMBER         | QTY. |
|----------|---------------------|------|
| 1        | 1x4x38              | 3    |
| 2        | 2x2x10              | 2    |
| 3        | 1x2x35              | 1    |
| 4        | 1 in Wood Screw     | 4    |
| 5        | 1 5-8 in Wood Screw | 6    |

**STEP 1: SIDE PANEL ASSEMBLY**  
**QTY: 2**

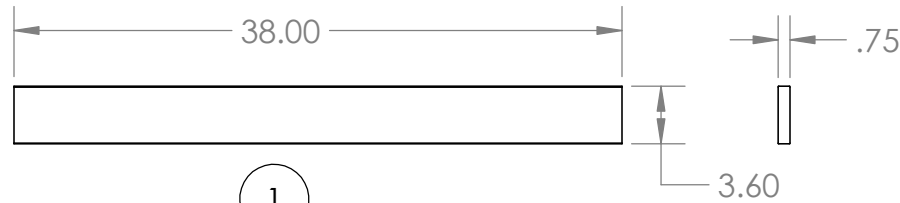

1  
Part #: 1x4x38  
Material: Pine  
QTY: 3

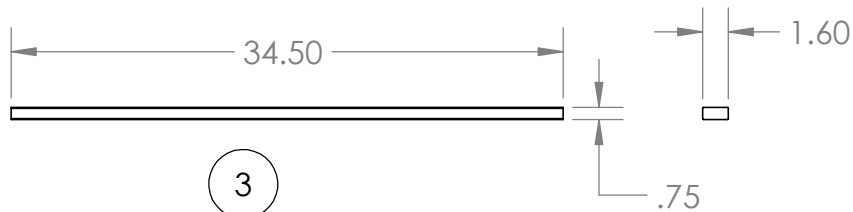

3  
Part #: 1x2x35  
Material: Pine  
QTY: 1

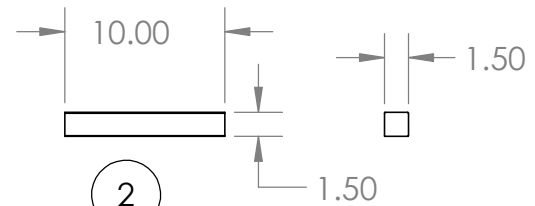

2  
Part #: 1x2x35  
Material: Pine  
QTY: 2

CAN REPLACE SCREWS WITH  
16 GA NAILS AND WOOD GLUE

PRE-DRILL HOLES TO  
PREVENT SPLITTING WOOD

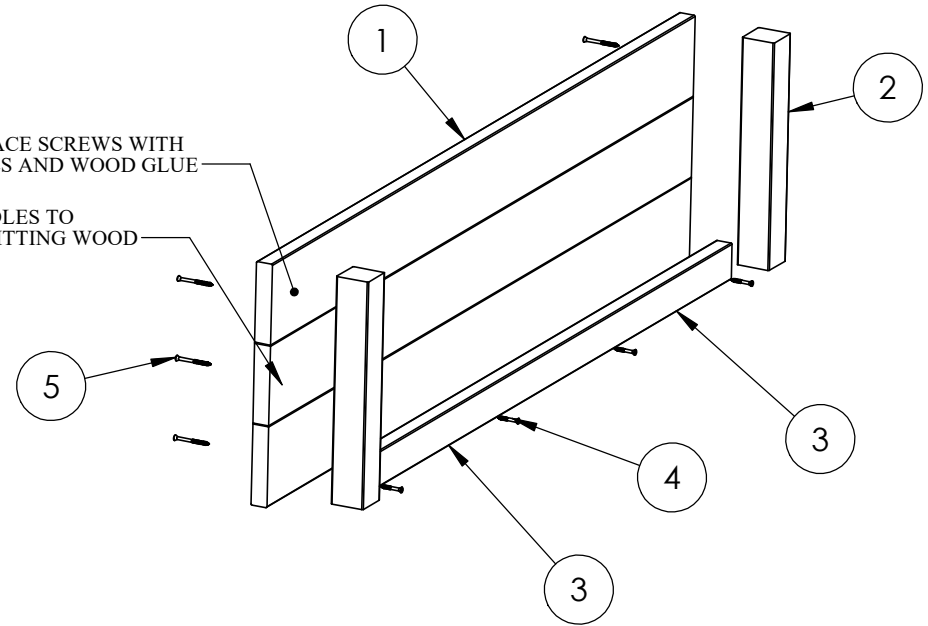

TITLE:

**ELEVATED GARDEN PLANTER**

SIZE

**A**

DWG. NO.

**BUILDING STEPS**

REV

SCALE: N/A

WEIGHT:

SHEET 1 OF 5



UNLESS OTHERWISE SPECIFIED:  
DIMENSIONS ARE IN INCHES  
TOLERANCES: ±0.0625 in

|                      | NAME | DATE |
|----------------------|------|------|
| DRAWN                |      |      |
| CHECKED              |      |      |
| COMMENTS:            |      |      |
| DO NOT SCALE DRAWING |      |      |

| ITEM NO. | PART NUMBER         | QTY. |
|----------|---------------------|------|
| 1        | Side Panel Assem    | 2    |
| 2        | 1x4x16              | 6    |
| 3        | 1 5-8 in Wood Screw | 12   |

**STEP 2: COMPLETING BOX**

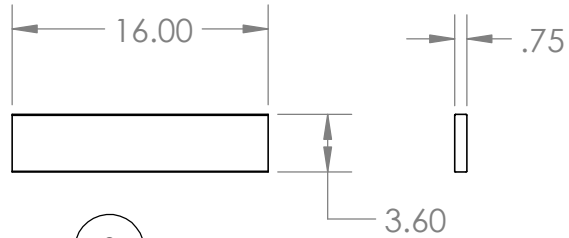

2  
 Part #: 1X4X16  
 Material: Pine  
 QTY: 6

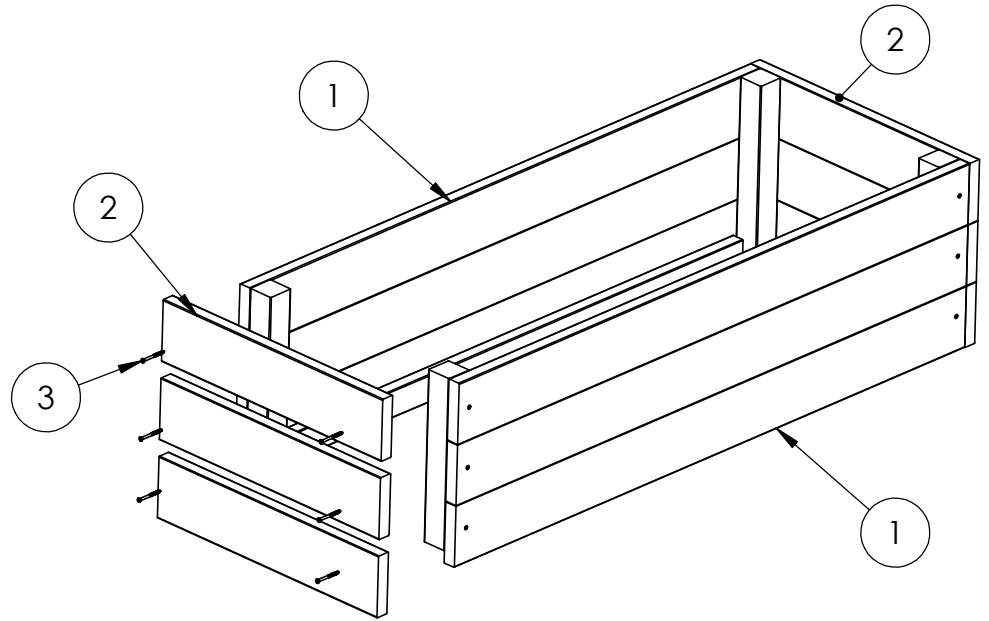

TITLE:  
**ELEVATED GARDEN PLANTER**



UNLESS OTHERWISE SPECIFIED:  
 DIMENSIONS ARE IN INCHES  
 TOLERANCES: ±0.0625 in

|                      | NAME | DATE |
|----------------------|------|------|
| DRAWN                |      |      |
| CHECKED              |      |      |
| COMMENTS:            |      |      |
| DO NOT SCALE DRAWING |      |      |

| SIZE       | DWG. NO.              | REV          |
|------------|-----------------------|--------------|
| <b>A</b>   | <b>BUILDING STEPS</b> |              |
| SCALE: N/A | WEIGHT:               | SHEET 2 OF 5 |

| ITEM NO. | PART NUMBER         | QTY. |
|----------|---------------------|------|
| 1        | Box Assem -2        | 1    |
| 2        | 1x3 Leg             | 4    |
| 3        | 1x4 Leg             | 4    |
| 4        | 1 5-8 in Wood Screw | 24   |

### STEP 3: ADDING LEGS

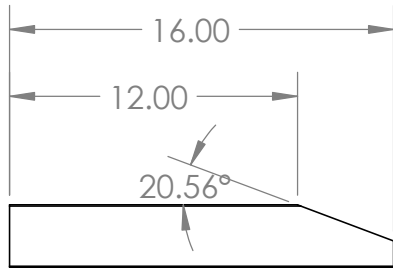
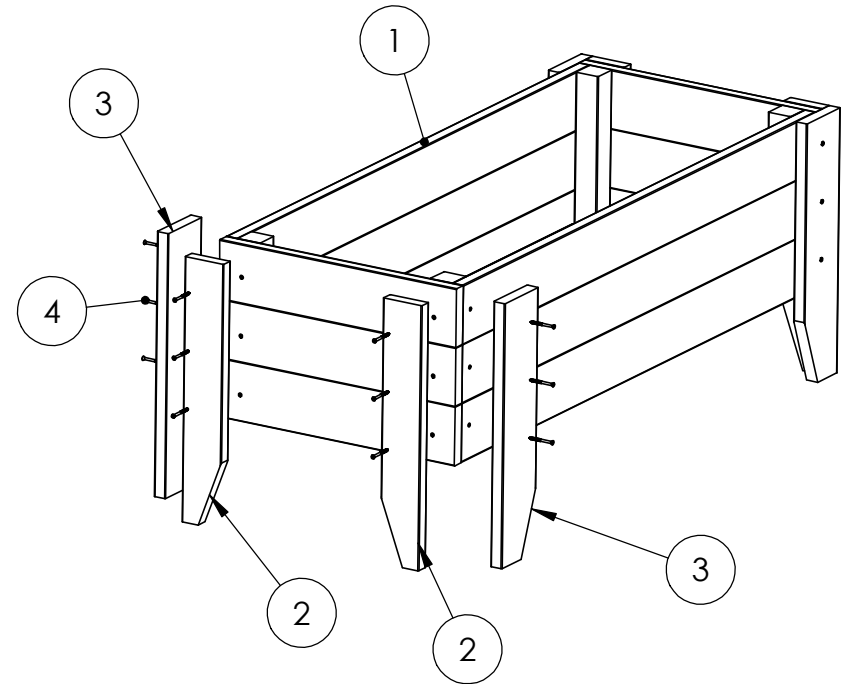

2  
Part #: 1x3 LEG  
Material: Pine  
QTY: 4

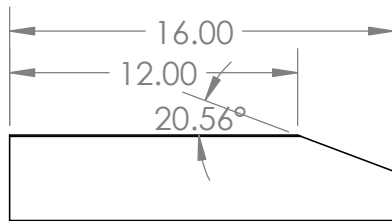
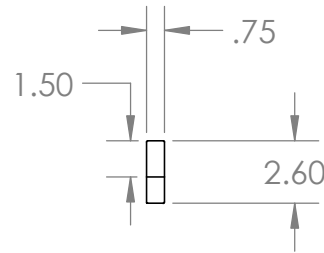

3  
Part #: 1x4 LEG  
Material: Pine  
QTY: 4

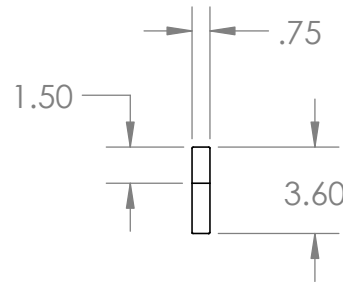

TITLE:  
**ELEVATED GARDEN PLANTER**

SIZE: **A** DWG. NO. **BUILDING STEPS** REV

SCALE: N/A WEIGHT: SHEET 3 OF 5



UNLESS OTHERWISE SPECIFIED:  
DIMENSIONS ARE IN INCHES  
TOLERANCES: ±0.0625 in

|                      | NAME | DATE |
|----------------------|------|------|
| DRAWN                |      |      |
| CHECKED              |      |      |
| COMMENTS:            |      |      |
| DO NOT SCALE DRAWING |      |      |

| ITEM NO. | PART NUMBER                  | QTY. |
|----------|------------------------------|------|
| 1        | Box Assem -3-1               | 1    |
| 2        | 1x4x14.25                    | 9    |
| 3        | 1x4x14.25 Corner Cut         | 1    |
| 4        | 1x4x14.25 Corner Cut - Short | 1    |
| 5        | 1.5 in - 18 GA Brad Nails    | 42   |

### STEP 4: ADDING BOTTOM

APPLY WOOD GLUE

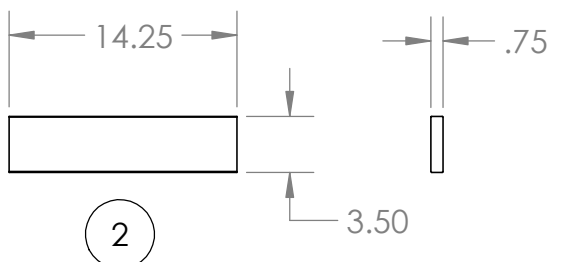
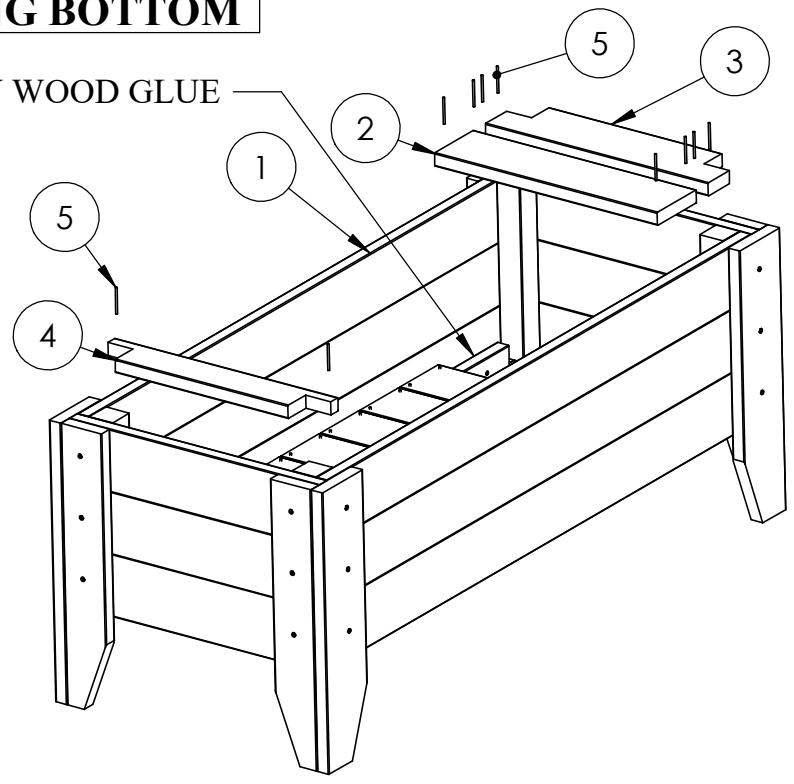

2  
Part #: 1X4X14.25  
Material: Pine  
QTY: 9

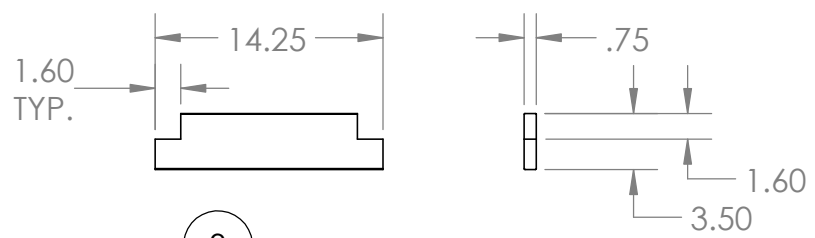

3  
Part #: 1X4X14.25 Corner Cut  
Material: Pine  
QTY: 1

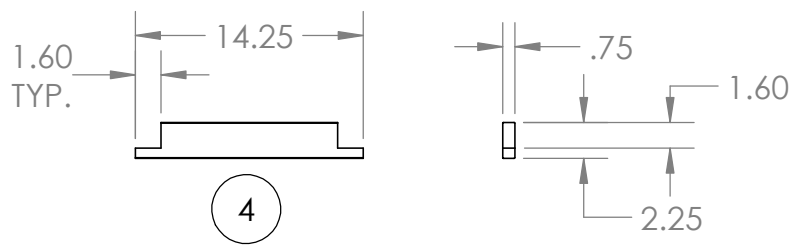

4  
Part #: 1X4X14.25 Corner Cut - Short  
Material: Pine  
QTY:1

|                                |                       |              |
|--------------------------------|-----------------------|--------------|
| TITLE:                         |                       |              |
| <b>ELEVATED GARDEN PLANTER</b> |                       |              |
| SIZE                           | DWG. NO.              | REV          |
| <b>A</b>                       | <b>BUILDING STEPS</b> |              |
| SCALE: N/A                     | WEIGHT:               | SHEET 4 OF 5 |



UNLESS OTHERWISE SPECIFIED:  
DIMENSIONS ARE IN INCHES  
TOLERANCES: ±0.0625 in

|                      | NAME | DATE |
|----------------------|------|------|
| DRAWN                |      |      |
| CHECKED              |      |      |
| COMMENTS:            |      |      |
| DO NOT SCALE DRAWING |      |      |

| ITEM NO. | PART NUMBER               | QTY. |
|----------|---------------------------|------|
| 1        | Box Assem -4-1            | 1    |
| 2        | 1x3 Long Moulding         | 2    |
| 3        | 1x3 Short Moulding        | 2    |
| 4        | 1.5 in - 18 GA Brad Nails | 16   |

## STEP 5: ADDING TOP CROWN MOLDING FINISHED PLANTER

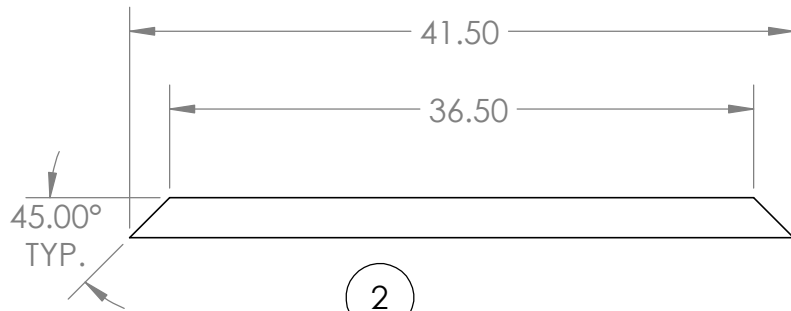

2  
Part #: 1x3xLong Moulding  
Material: Pine  
QTY: 2

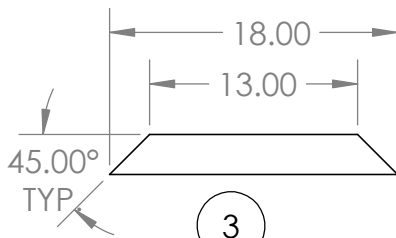
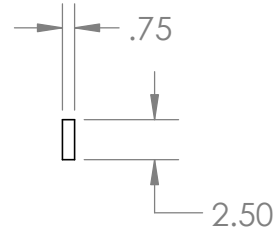

3  
Part #: 1x3xShort Moulding  
Material: Pine  
QTY: 2

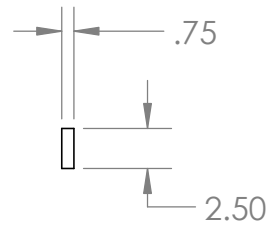

APPLY WOOD GLUE  
AROUND THE TOP  
BEFORE PUTTING MOLDING

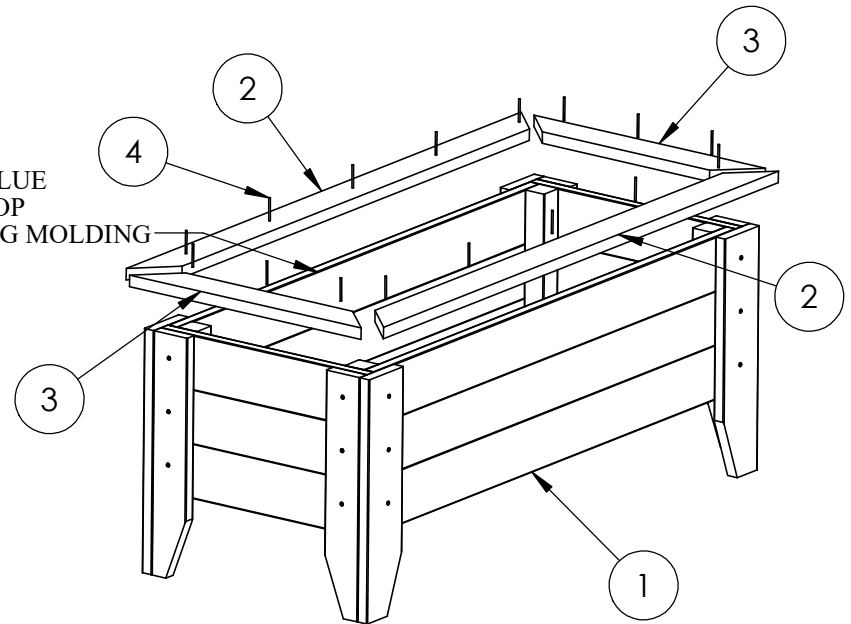

TITLE:  
**ELEVATED GARDEN PLANTER**

SIZE: **A** DWG. NO. **BUILDING STEPS** REV

SCALE: N/A WEIGHT: SHEET 5 OF 5



UNLESS OTHERWISE SPECIFIED:  
DIMENSIONS ARE IN INCHES  
TOLERANCES: ±0.0625 in

|                      | NAME | DATE |
|----------------------|------|------|
| DRAWN                |      |      |
| CHECKED              |      |      |
| COMMENTS:            |      |      |
| DO NOT SCALE DRAWING |      |      |